

Coaxial Directional Coupler

50Ω 13dB 800 to 2000 MHz

NEW!
ZNDC-13-2G



CASE STYLE: FM587
PRICE: \$49.95 ea. QTY (1-9)

Maximum Ratings

Operating Temperature	-55°C to 100°C
Storage Temperature	-55°C to 100°C
Power Input	3W Max.

Pin Connections

INPUT	1
OUTPUT	2
COUPLED	3

Features

- excellent insertion loss, 0.8 dB typ.
- very flat coupling, ± 0.2 dB typ.

Applications

- cellular
- PCS
- ISM

Directional Coupler Electrical Specifications

FREQ. RANGE (MHz)	COUPLING (dB)		MAINLINE LOSS (dB)		DIRECTIVITY (dB)		VSWR (:1)	POWER INPUT (W)
	Nom.	Max. Flatness	Typ.	Max.	Typ.	Min.		
f_c - f_u								
800-2000								
800-1000	13 \pm 0.5	\pm 0.3	0.8	1.1	20	17	1.4	3
1000-1700	13 \pm 0.5	\pm 0.3	0.8	1.3	20	18	1.15	3
1700-2000	13 \pm 0.5	\pm 0.35	0.8	1.3	25	14	1.2	3

Outline Drawing

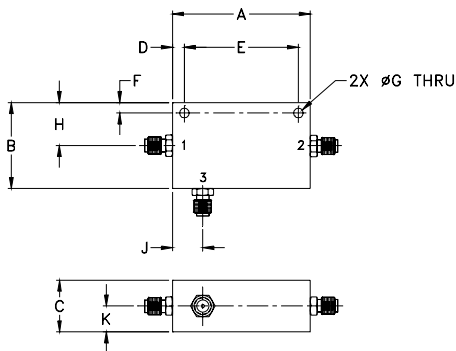

Outline Dimensions (inch/mm)

A	B	C	D	E	F	G	H
2.00	1.25	.75	.17	1.656	.15	.140	.63
50.80	31.75	19.05	4.32	42.06	3.81	3.56	16.00

J	K	wt.
.44	.38	grams
11.18	9.65	57

Typical Performance Data

Frequency (MHz)	Insertion Loss (dB) In-Out	Coupling (dB) In-Cpl	Directivity (dB)	Return Loss (dB)		
				In	Out	Cpl
800.00	0.74	13.12	20.06	14.58	14.10	14.22
900.00	0.73	13.07	21.47	15.88	15.36	15.17
1000.00	0.72	13.03	22.82	17.25	16.66	16.13
1100.00	0.73	12.99	24.27	18.63	18.00	17.12
1300.00	0.75	12.94	27.24	21.86	20.85	19.17
1500.00	0.80	12.93	29.25	25.65	23.33	20.92
1700.00	0.85	12.96	26.89	29.51	24.07	21.11
1800.00	0.87	13.00	24.62	31.04	23.92	20.31
1900.00	0.90	13.05	22.37	32.35	23.61	19.06
2000.00	0.93	13.12	20.21	33.35	23.36	17.61

